

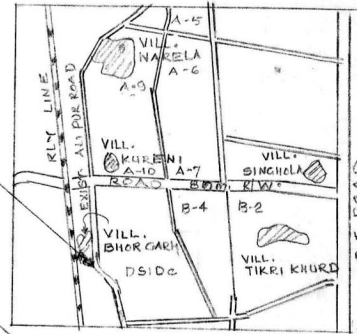

DELHI DEVELOPMENT AUTHORITY

दिल्ली विकास प्राधिकरण

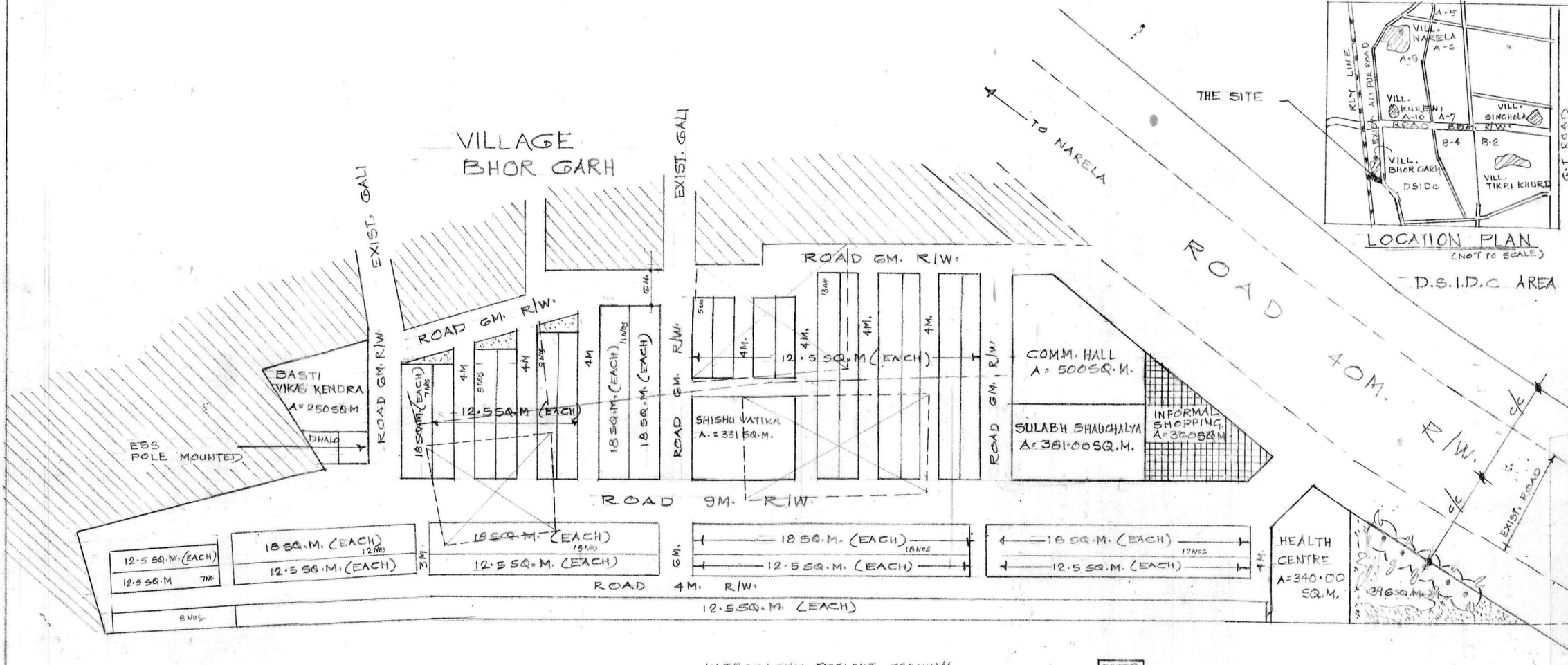

AREA STATEMENT

TOTAL SCHEME AREA = 13904.50 SQ.M.
AREA UNDER RESIDENTIAL = 5275.5 SQ.M. = 37.94 %
AREA UNDER INF. SHOPPING = 3600 = 2.59 %
AREA UNDER FACILITIES = 1860.0 = 13.37 %
AREA UNDER PARK = 456.0 = 3.28 %
AREA UNDER ROADS = 5953.0 = 42.82 %

DETAIL OF PLOTS

(i) 3M X 6M = 18 SQ.M. = 91 NOS.
(ii) 3M X 4.166M = 12.5 SQ.M. = 291 NOS.
TOTAL = 382 NOS.

THERE MAY BE MINOR ADJUSTMENT IN THE NO. OF PLOTS WHILE TAKING UP THE ACTUAL DEMARICATION AT SITE (DRAFT)

LAY OUT PLAN FOR J.J. PLOTS ALONG NARELA ALIPUR ROAD VILL. BHOR GARH.

scale: 1:500	date: 05.04.2004	north	उत्तर
names: SHEKHAR SINGH, R.K. SAINI, P.L.G. ASST.	Y.P. Director, Asst. Dir. सहायक निदेशक		
A.K. BHATTACHARYA, J.P. dy. director, उप निदेशक	D. SALUNGA, project planner, परियोजना नियोजक		
drawing no: 425		डाईंग नं.	

LAND IS HANDED OVER TO ENGG. DEPT
LAYOUT IS FEASIBLE AT SITE AFTER REMOVAL
OF UNAUTHORISED CONSTR. & SHIFTING OF 11 KV LINE

INTEGRATED FREIGHT TERMINAL

UN-AUTHORISED STRUCTURES TO BE REMOVED.
THIS DRG. HAS BEEN APPROVED IN THE 229TH SCREENING
COMMITTEE MEETING HELD ON 15/10/04 VIDE ITEM NO. 14/2004
IN THE FILE NO. F.17(407)2K/N/P/PART IV

NARELA PROJECT
नरेला परियोजना